

## PSB-2BOLT Configuration

The PSB-2BOLT design is attached to a given clamping surface using two socket head cap screws. The PSB-2BOLT design holds the bearing in an upright position, allowing for a stylish, slim profile fit for space confined applications.

**PSB-2BOLT Capacity Table**

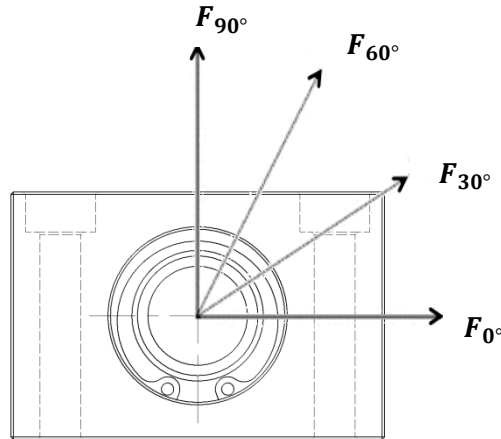

Shaft Size (mm)	Static Breaking Load Capacities (kN) for PSB-2BOLT Housings			
	$F_{0^\circ}$	$F_{30^\circ}$	$F_{60^\circ}$	$F_{90^\circ}$
15	11.0	22.2	22.9	11.6
20	41.4	60.0	68.0	50.3
30	78.9	116.7	109.5	70.9
40	128.4	176.3	223.7	159.1
50	218.7	318.2	320.1	220.5

### Attachment Bolts

Breaking loads shown above can be approached by using UNBRAKO High Tensile Cap Screws. Attachment bolt loadings and capacity should be determined independently. This is to account for different bolt types and different surface conditions with regard to the clamping surface.

### Housing Materials

The values in the Static Breaking Load Capacity for PSB Eyeball Housings (kN) Table are for a PSB Eyeball Housing made from zinc plated bright mild steel. Housings can be made from aluminium, bronze, stainless steel, zinc plated bright mild steel and a variety of plastics such as UHMWPU to suit a range of environmental conditions. Note that by selecting a material which is **not** zinc plated bright mild steel, the static load capacities in the table above do not apply.

Note that the bearing is located in the centre of the housing.

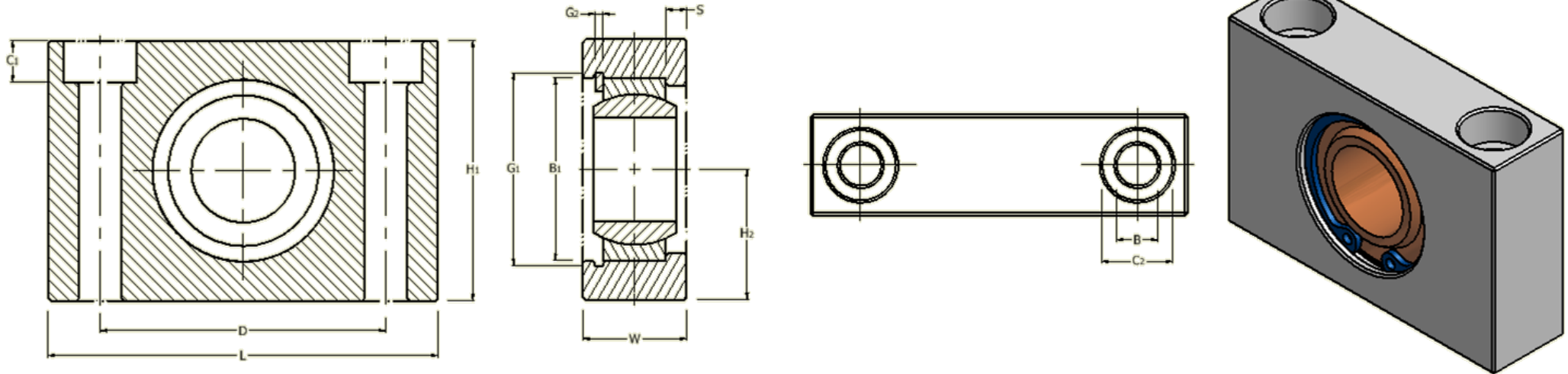

Housing Dimensions (mm)													
Shaft Diameter (mm)	Bearing Groove Diameter	Bearing Groove Width	Shoulder Diameter	Circlip Groove Width	Circlip Groove Thickness	Height	Base Distance to Center of Bearing	Width	Distance between Holes	Base Length	Bolt Hole Diameter	Counterbore Depth	Counterbore Diameter
	B <sub>1</sub>	B <sub>2</sub>	S	G <sub>1</sub>	G <sub>2</sub>	H <sub>1</sub>	H <sub>2</sub>	W	D	L	B	C <sub>1</sub>	C <sub>2</sub>
Tolerances (mm)													
	M7 Fit	+0.1 −0.0	+0.5 −0.5	+0.1 −0.0	+0.1 −0.0	—	+0.1 −0.1	+0.2 −0.0	+0.1 −0.1	—	+0.1 −0.0	+0.2 −0.0	+0.2 −0.0
15	26	9	24	27.2	1.1	30	15	15	36	50	6.25	6	11
20	35	12	32	37	1.6	50	25	20	55	75	8.25	8	14
30	47	18	43	49.5	1.85	60	30	30	74	100	12.25	12	19.5
40	62	22	57	65	2.15	85	42.5	40	100	140	20.25	20	32.5
50	75	28	70	78	2.65	100	50	50	120	160	20.25	20	32.5

### **Suitable Bearings for PSB- 2BOLT Housings**

Bearings which are suitable for use in the PSB- 2BOLT Housing include the GE C series (steel sinter/bronze composite), the GE TXE-2LS series (steel/PTFE fabric, sealed on both sides) and the GE TXG3E-2LS series (steel/PTFE fabric, sealed on both sides, stainless steel). These bearings are available for 20, 30, 40 and 50mm shaft size PSB- 2BOLT Housings. The only bearing material available for the 15mm shaft size is the GE C series (steel sinter/bronze composite).

### **Special Purpose Housings on Request**

Special purpose housings can be supplied on request. We can accommodate bearings of different size, load rating, and angle of slew. Please use the **enquiry form** on the website or send a request to **accounts@pegasusdesigns.com.au** with the specifications of the desired bearing, as well as any special purpose requirements, such as a preferred housing material, environmental conditions, or required heavy load capacity.